

# ASSEMBLY MANUAL OF RTV AND RTV-SAT OUTLET SOCKETS

1. Prepare end of the antenna cable for installation, i.e. strip the wire of the coaxial cable by cutting at the same height the external insulation, over-wrap and the centre of the cable. (picture no. 1)
2. Unscrew the clamping bolt in the antenna outlet socket (picture no. 2).
3. Insert the antenna cable so as blade of the socket enters between the over-wrap and the external insulation. Check if the wires of the cable are inserted into the input clamp in a correct way (picture no. 4).
4. Tighten the clamping bolt in the antenna outlet socket (picture no. 5).
5. For pass-through sockets - procedure for socket output is the same as for socket input.
6. Insert the socket into the  $\varnothing 60\text{mm}$  installation box and according to the type of box assembly the socket with either the spikes or the fastening screws.
7. Place the frame with the cap on the main body of the outlet socket..

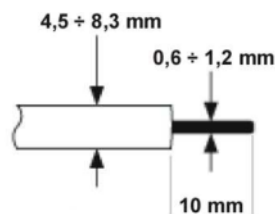

PICTURE NO.1

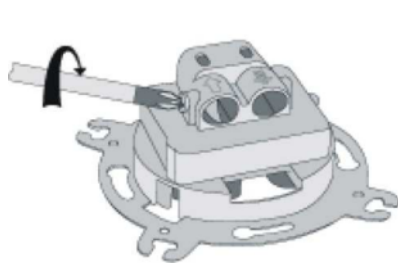

PICTURE NO.2

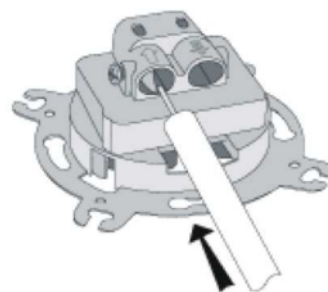

PICTURE NO.3

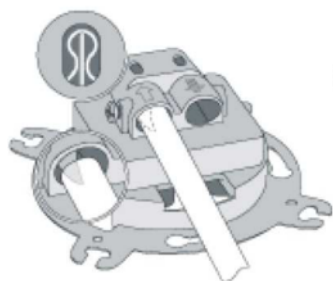

PICTURE NO.4

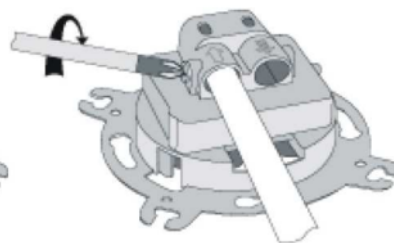

PICTURE NO.5

## NOTE!

Assembly shall be held by a suitably qualified person with deactivated voltage and shall meet the national safety standards.